

S 550 HD (H or V) LESS STEEL

Return Air Grille

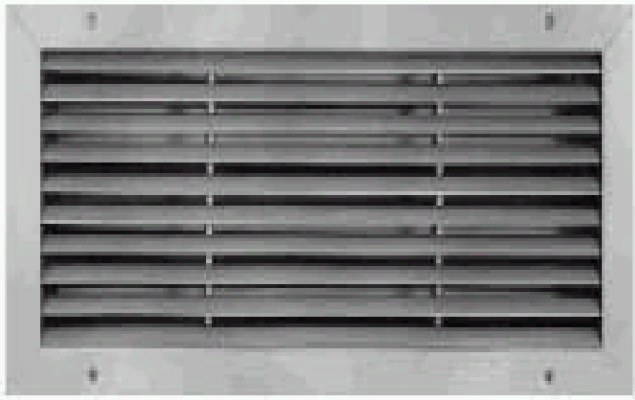

The series 550 HD Heavy-Duty reinforced return air grille is styled to match the 150 and 250 supply grilles. The face bars are non-adjustable and available in either a horizontal or vertical position, factory set at either 0 or 45 degrees, spaced on .750" centers (with optional .500" centers at an *additional cost.*)

The same hollow air-foil bars used on the supply grilles are used on the return air grilles, blades are reinforced from the back on 6" - 8" centers.

Available with horizontal face bars, 550HD-H, or vertical face bars, 550HD-V. Constructed from type 304 stainless, satin finish standard. Type 316 stainless steel is also available at an additional cost.

Specify series S-44 opposed blade damper attached to the 550HD series to make return registers. The S-44 OBD assures even distribution of air across the grille face as well as positive volume control.

SEE OPTIONS PAGES:

Factory Standards

- Air foil blades individually fixed at 45° or 0°.
- Type 304 stainless.
- #6 x 1 1/4" stainless sheet metal screws.
- #4 satin polished finish.

Factory Options (extra charge)

- Type 316 stainless, satin finish.
- 1 1/2" blade centers.
- Painted finish.

| Minimum W x H | Maximum W x H |
|---------------|---------------|
| 4" x 4" | 60" x 48" |

U.S. Units to Metric Conversion

INCHES x (25.4) = MILLIMETERS

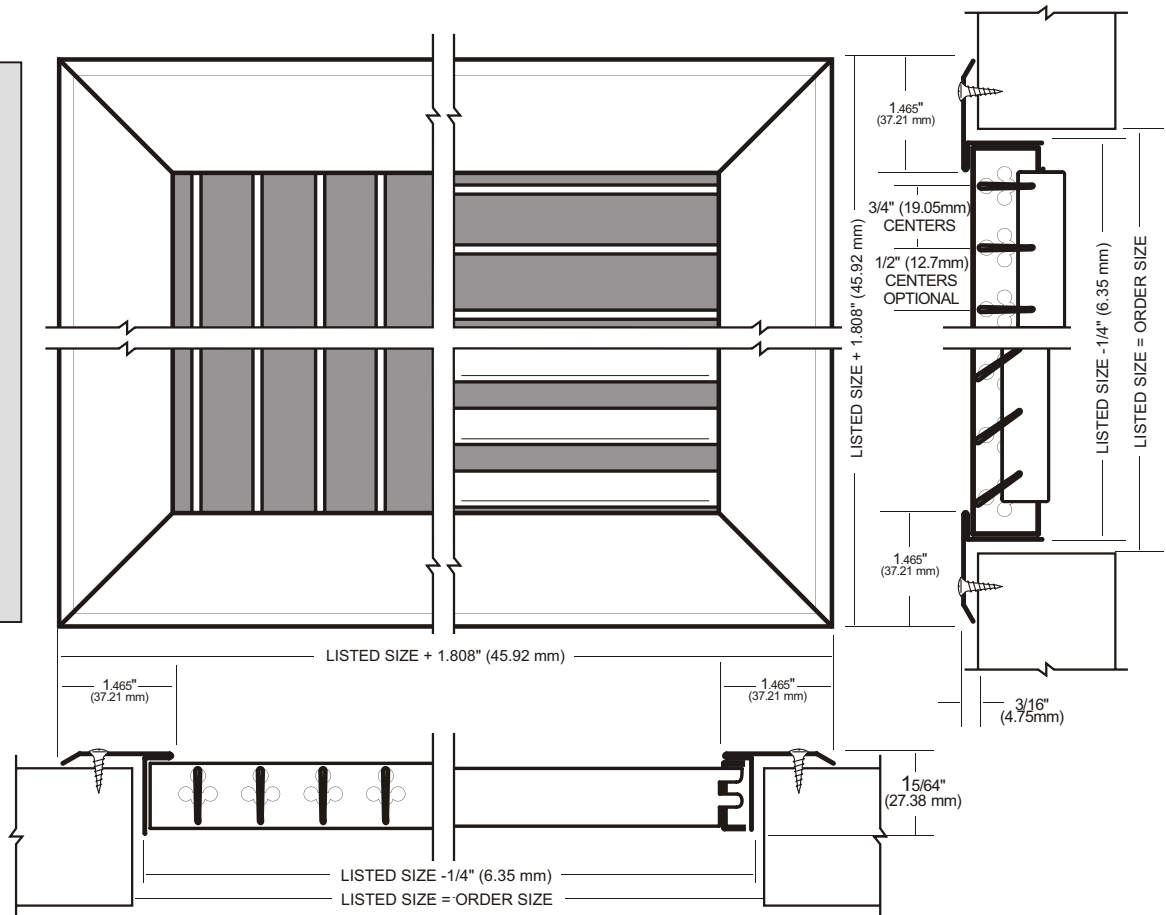

| CUSTOMER ORDER NO. -- | | | | |
|-----------------------|--------------------|--------------|----------------------|------------|
| JOB -- | | | | |
| ARCHITECT -- | | | | |
| CUSTOMER -- | | | | |
| QTY | ORDER SIZE (W x H) | DAMPER (Y/N) | 3/4" OR 1/2" CENTERS | 304 OR 316 |
| | | | | |
| | | | | |
| | | | | |
| | | | | |